

MODEL NO.			MODEL NAME
42111002			ASSY,CYL, BB, MM, 17,8KN, 12,5 STRK,SA
NO.	QTY	PART NO.	DESCRIPTION
1	1	23050012	SNAP RING, INTERNAL
2	1	39010014	SEAL, BEVEL, 13/16 x 3/32 x 1
3	1	39012008	WIPER,SNAP-IN, (13/16)
4	2	39050042	O-RING, (-011)
5	1	43068004	PLUG, 1/8 BSPP
6	1	48011000	METRIC PISTON, CYL., 12,5 STRK., 17,8 kN
7	1	82031002	GLAND,CYL, 3900 & 17.8 KN
8	1	92060001	SPRING, PAK
N/A	N/A	60210301	KIT, SEAL, BB, 17,8 KN, SA
N/A	N/A	6V210111	KIT, SEAL, BB, 3900/17,8 KN, SA, FKM
N/A	N/A	61210311	KIT, SPRING, BB, 17,8 KN

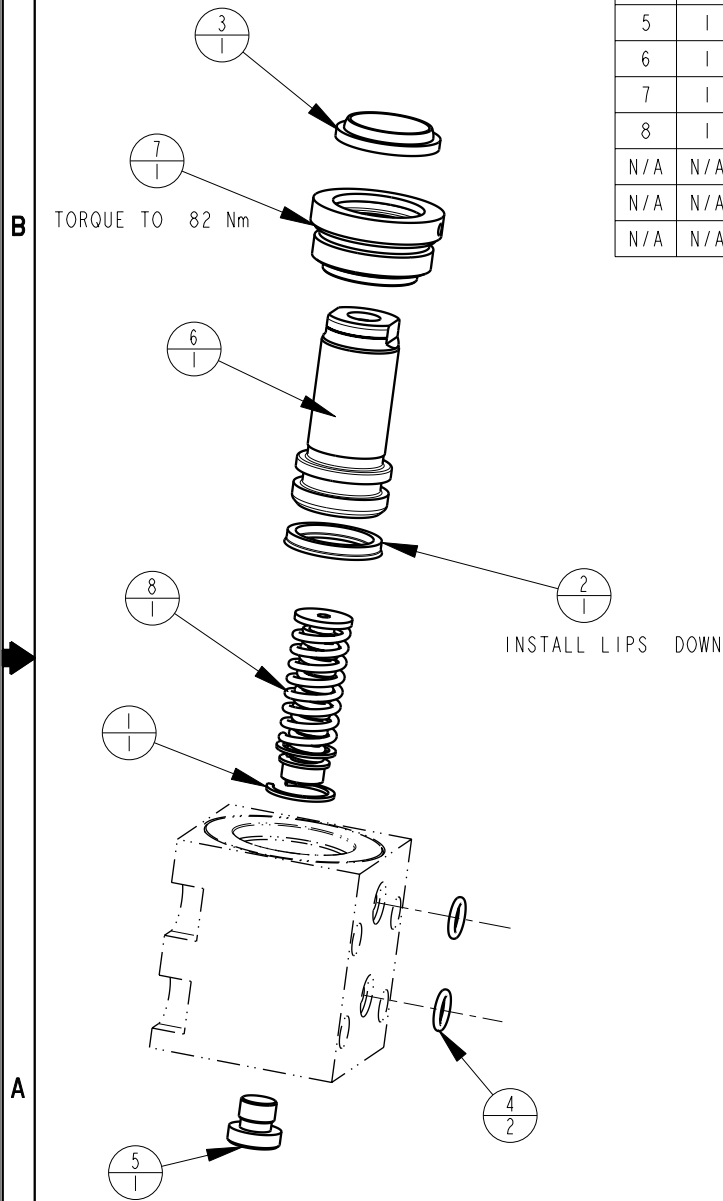

3. SPRING PAK AND RETAINING RING ARE INCLUDED IN THE SPRING KIT.
2. ALL SEALS, O-RINGS, AND WIPERS ARE INCLUDED IN THE STANDARD OR FKM SEAL KIT.
1. APPLY LUBRICANT TO ALL SEALS PRIOR TO ASSEMBLY (DO NOT USE SILICONE TYPE LUBRICANTS).

NOTE:

### PARTS LIST



VEKTEK, INC.  
1334 E. SIXTH AVE. P.O. BOX 625  
EMPORIA, KS. 66801 U.S.A.

ASSEMBLIES AFFECTED  
42-1110-02

PARTS LIST, BB, MM, 17,8 KN, SA

B	2625	RELEASE	GAR	2/28/14
REV	IN ACCORDANCE WITH ECN	EFFECTIVE DATE	REVISED BY	DATE
DRW BY:	G. ROMINE	<b>DRAWING STATUS: Released</b>		
DATE:	11/19/07	PRODUCTION APPROVED FOR RELEASED STATUS ONLY		

SIZE A	MPLV2167	REV B
-----------	----------	----------

FORM FEG035\_PL\_ASIZE, REV. B

SHEET 1 OF 1